



TOPGOLF

EXTERIOR SIGN
2020 CATALOG



cima[^]

TOPGOLF

EXTERIOR SIGN CATALOG

CONTENTS

BUILDING STYLE

2	=====	GUIDE AND LOGO
3	=====	FLEX
5	=====	SELECT
8	=====	EZ
11	=====	GEN2
14	=====	BUILDING SIGNS
21	=====	FREESTANDING SIGNS
24	=====	MISCELLANEOUS SIGNS
26	=====	CUSTOM SIGNS GALLERY



GUIDE AND LOGO BRANDING

BUILDING STYLES



Flex



Select



EZ



Gen 2

BRANDING

Fonts

LOGO: Topgolf custom font
PRIMARY: Shield Sans
SECONDARY : Teeline, Topgolf



TOPGOLF

Vertical



TOPGOLF

Horizontal

PMS	293 U / 7686 C
CMYK	97, 77, 14, 2
RGB	11, 76, 140
HEX	00b4c8c

PMS	400 U / C: 20% Tint
CMYK	5, 5, 5, 0
RGB	244, 242, 239
HEX	f4f2ef

The off-white may be used for subtle contrast, but in all print instances - white is preferred.

SIGN CLEARANCES

SIGN STYLE



TOPGOLF

TOPGOLF



SPACING

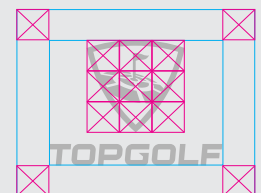
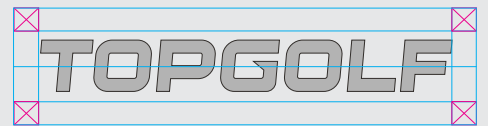



BUILDING TYPE:
FLEX



AUGUSTA, GA



AUGUSTA, GA



AUGUSTA, GA





BUILDING TYPE: FLEX



- Augusta, GA
- Chattanooga, TN

TOPGOLF

DETAILS

The Topgolf Flex building exterior package consist of Topgolf canopy channel letters above the main entrance, the site's address in dimensional letters, the halo logo sign, and asphalt stencils for parking spaces and sidewalk.

36" TOPGOLF CHANNEL LETTERS

White Illuminated Topgolf channel letters for the Flex building main entrance canopy

SIZE: 3' (H) x 24' 0 5/8" (W)
72.14 Sq. Ft.

FACE: 3/16" White Acrylic
BACK: 1/8" Aluminum Welded To Returns
RETURNS: .063 Aluminum
LEDS: 6500K White Principal Qwik Mod 3
POWER SUPPLY: (6) Principal 60w 12V DC Class 2 Power Supply.

12" NON-ILLUMINATED DIMENSIONAL NUMERALS

Topgolf address dimensional numerals. Width of sign depends upon the number of numerals in site location's address.

1' 0" (H)

- FACE:** .090" Thick Routed Aluminum
- RETURNS:** .063" Formed Aluminum Welded To Faces
- SPACERS:** 1"Ø X 3-3/16" Long

0 0 0 0 0

HALO LOGO

Topgolf illuminated Halo Logo Sign

7' 9" (H) x 9' 10" (W)

- FACE:** .090" Thick Routed Aluminum
- RETURNS:** .080" Formed Aluminum
- BACKGROUND:** Routed 1/8" Thick Aluminum
- FRAME:** Extruded Aluminum #1631 Frameless Retainer & #1600 7/12 Retro Body



OPTIONAL

ASPHALT STENCIL

Topgolf Logo applied directly to parking surface or sidewalk. Asphalt stencil or painted.

5' 8" (H) x 6' 6" (W)





BUILDING TYPE:
SELECT

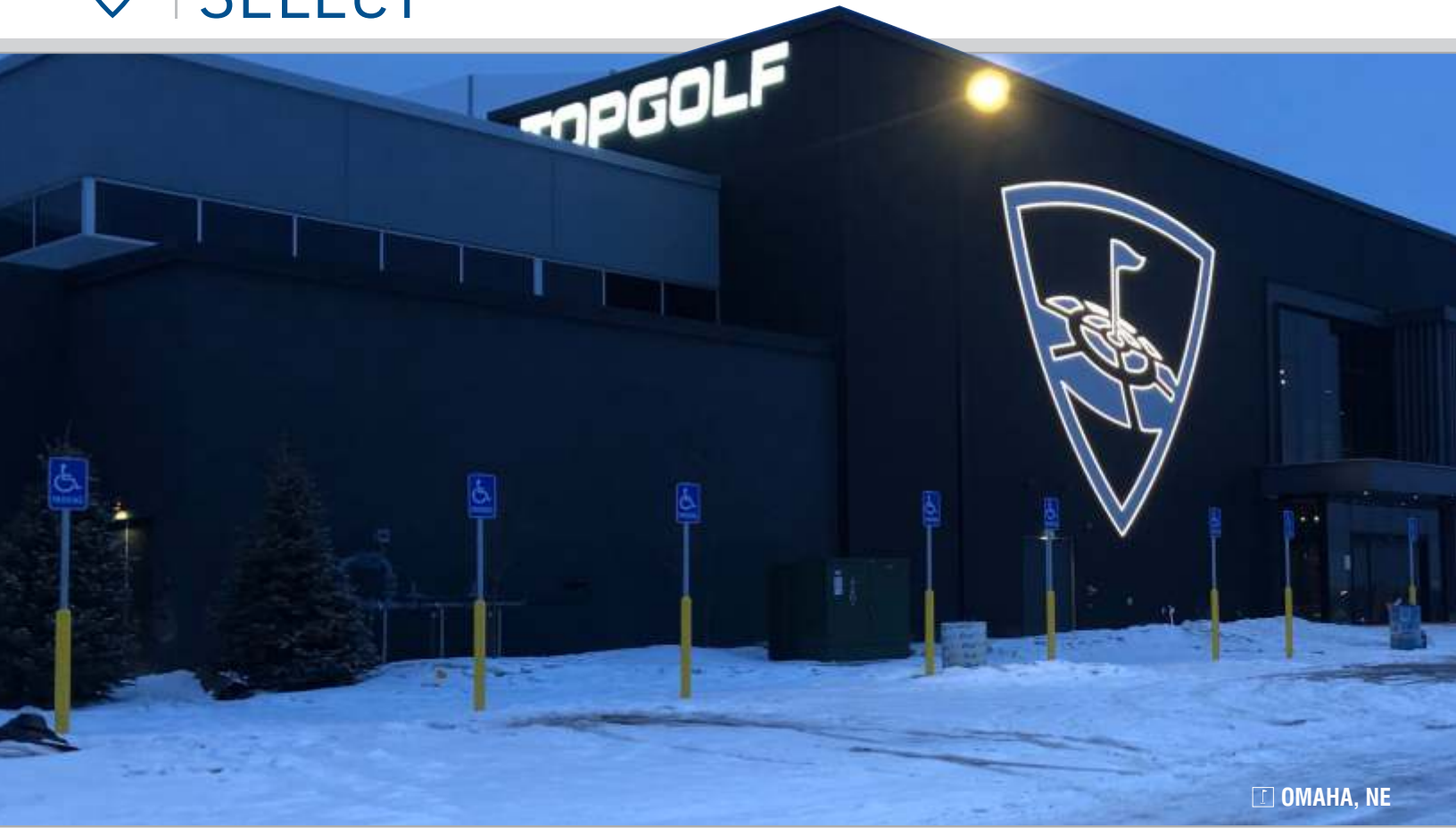

OMAHA, NE



ROGERS, AR





- Omaha, NE
- Rogers, AR

TOPGOLF

00000

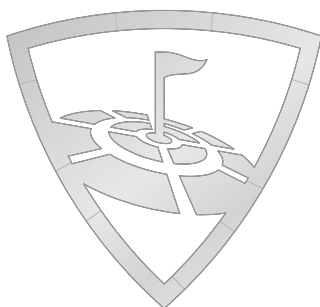

DETAILS

The Topgolf Select exterior package consists of Topgolf white channel letters, the sites' address in dimensional letters, an additional Topgolf text and logo channel letters for wing walls, and our standard monument or pylon.

48" "TOPGOLF" CHANNEL LETTERS

White Illuminated Topgolf channel letters for the Select building main entrance canopy.

SIZE: 4' 0" (H) x 32' 0 3/16" (W)

FACE: .177" Polycarbonate

BACK: 1/8" Aluminum Welded To Returns

RETURNS: .063 Aluminum

LEDS: 6500K White Principal Qwik Mod 3

POWER SUPPLY: (6) Principal 60w 12V DC Class 2 Power Supply.

24" NON-ILLUMINATED DIMENSIONAL NUMERALS

Topgolf address dimensional numerals. Width of sign depends upon the number of numerals in site location's address.

2' 0" (H)

1. FACE: .090" Thick Routed Aluminum

2. RETURNS: .063" Formed Aluminum Welded To Faces

3. SPACERS: 1"Ø X 3-3/16" Long

SHIELD CHANNEL LETTER

Topgolf address dimensional numerals. Width of sign depends upon the number of numerals in site location's address.

26' 5" (H) x 27' 10 1/2"

FACE: 1/8" Aluminum

BACK: 1/8" Aluminum Welded To Returns

RETURNS: .063 Aluminum

LEDS: White GLLS neon flex LEDs

POWER SUPPLY: Principal 12V DC Class 2 Power Supply

TOPGOLF MONUMENT

Fabricated Main Support cabinet, curved letter carrier, and base. "TOPGOLF" channel letter faces and shield logo cabinet with retainers & internally illuminated with 6500K white LED modules. Removable top panel for maintenance.

9' 5" (H) x 13' 4" (sizes may vary)

FACE: 1/8" Thick Routed Aluminum

RETURNS: 1/8" Formed Aluminum Welded To Faces

FOUNDATION: 3000 PSI concrete footing





GALLERY
SELECT



Rogers, AR



Omaha, NE



Rogers, AR



Omaha, NE



Rogers, AR



Omaha, NE





BUILDING TYPE:
EZ



GLENDALE, AZ



BATON ROUGE, LA



MYRTLE BEACH, FL



GREENVILLE, SC



SCHAUMBURG, IL



CLEVELAND, OH



THORNTON, CO





EXTERIOR SIGNS EZ



- Baton Rouge, LA
- Cleveland, OH
- Glendale, AZ
- Schaumburg, IL
- Greenville, SC
- Myrtle Beach, FL
- Pharr, TX
- Richmond, VA

TOPGOLF

00000



DETAILS

The Topgolf EZ exterior package consists of Topgolf white channel letters, the sites' address in dimensional letters, and Topgolf monument sign. For more exposure, our large "Shield" Channel Letter and Topgolf Text and Logo Channel Letters make excellent additions to any location.

64" TOPGOLF CHANNEL LETTERS

White Illuminated Topgolf channel letters for the EZ building main entrance.

SIZE: 5' 4"(H) x 41' 0 5/16"(W) - 213.5 Sq. Ft.

FACE: .177" Polycarbonate

BACK: 1/8" Aluminum Welded To Returns

RETURNS: .063 Aluminum

LEDS: 6500K White Principal Qwik Mod 3

24" NON-ILLUMINATED DIMENSIONAL NUMERALS

Topgolf address dimensional numerals to wing wall.

SIZE: 2' 0"(H)

1. **FACE:** .090" Thick Routed Aluminum

2. **RETURNS:** .063" Formed Aluminum Welded To Faces

3. **SPACERS:** 1"Ø X 3-3/16" Long

OPTIONAL

SHIELD LOGO AND TOPGOLF CHANNEL LETTERS

Shield logo and Topgolf channel letter set, for main entrance or wing wall.

Note: to be used when code will not allow LED logo feature.

SIZE: 7' 3 7/8"(H) x 49' 3 11/16"

FACE: 3/16" White Polycarbonate

RETURNS: .063 Aluminum

LEDS: 6500K White Principal Qwik Mod 3

OPTIONAL

SHIELD CHANNEL LETTER

Topgolf shield channel attached to wing wall or other locations based on site specific considerations.

SIZE: 7' 11 1/4"(H) x 8' 4 1/16"

FACE: .177" Polycarbonate

LEDS: 6500K White Principal Qwik Mod 3

POWER SUPPLY: Principal 12V DC Class 2 Power Supply

TOPGOLF MONUMENT

Fabricated Main Support cabinet, curved letter carrier, and base. Internally illuminated with 6500K white LED modules.

SIZE: 9' 5"(H) x 13' 4"

FACE: 1/8" Thick Routed Aluminum

RETURNS: 1/8" Formed Aluminum Welded To Faces

FOUNDATION: 3000 PSI concrete footing





Greenville, SC



Richmond, VA



Schaumburg, IL

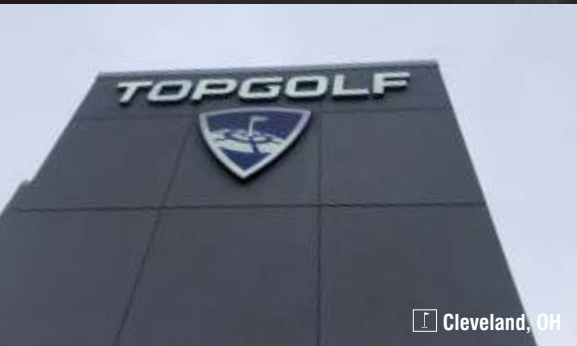

Cleveland, OH



Glendale, AZ



Glendale, AZ



BUILDING TYPE:
GEN-2



FORT WORTH, TX



WEST CHESTER, OH



MIAMI GARDENS, FL



MT. LAUREL, NJ



ORLANDO, FL



EL PASO, TX



ATLANTA MIDTOWN, GA



CENTENNIAL, CO



NASHVILLE, TN



HILLSBORO, OR





EXTERIOR SIGNS GEN-2



- Birmingham, AL
- Centennial, CO
- Charlotte, NC
- El Paso, TX
- Hillsboro, OR
- Houston, TX
- Jacksonville, FL
- Miami, FL
- National Harbor, MD
- Orlando, FL
- Salt Lake City, UT
- Webster, TX

TOPGOLF



DETAILS

The Topgolf Gen 2 building exterior package consist of Topgolf blue canopy channel letters above the main entrance, the site's address in dimensional letters, an additional Topgolf text and logo channel letters for walls, and our standard monument.

42" TOPGOLF BLUE CHANNEL LETTERS

Blue Illuminated Topgolf channel letters for the Gen-2 building main entrance canopy.

SIZE: 3' 6"(H) x 26' 10 7/8"(W) - 94.17 Sq. Ft.

FACE: 3/16" Acrylic

VINYL: 3M 3630-157 Sultan Blue (Trans)

LEDS: 6500K White Principal Qwik Mod 3

24" NON-ILLUMINATED DIMENSIONAL NUMERALS

Topgolf address dimensional numerals to wing wall.

SIZE: 2' 0"(H)

1. FACE: .090" Thick Routed Aluminum

2. RETURNS: .063" Formed Aluminum Welded To Faces

3. SPACERS: 1"Ø X 3-3/16" Long

OPTIONAL

TOPGOLF TEXT AND LOGO CHANNEL LETTER

Illuminated Blue Topgolf Text and Logo channel letters for the building side entrance.
Note: to be used when code will not allow LED logo feature.

SIZE: 3' 6"(H) x 32' 4"(W)

FACE: 3/16" Acrylic

VINYL: 3M 3630-157 Sultan Blue (Transparent)

LEDS: 6500K White Principal Qwik Mod 3

OPTIONAL

TOPGOLF TEXT AND LOGO CHANNEL LETTER

Illuminated Blue Topgolf Text and Logo channel letters for the wing wall or other locations based on site considerations.

SIZE: Varies with Code Allowances

FACE: 3/16" Acrylic

VINYL: 3M 3630-157 Sultan Blue (Transparent)

LEDS: 6500K White Principal Qwik Mod 3

TOPGOLF MONUMENT

Fabricated Main Support cabinet, curved letter carrier, and base. Internally illuminated with 6500K white LED modules.

SIZE: 9' 5"(H) x 13' 4"

FACE: 1/8" Thick Routed Aluminum

RETURNS: 1/8" Formed Aluminum Welded To Faces

FOUNDATION: 3000 PSI concrete footing





GALLERY GEN 2



Hillsboro, OR



Germantown, MD



Atlanta-Midtown, GA



Salt Lake City, UT



Mt. Laurel, NJ



Germantown, MD
CUSTOM DESIGN





BUILDING SIGNS

CHANNEL LETTERS

MAIN ENTRY: EZ, SELECT, FLEX

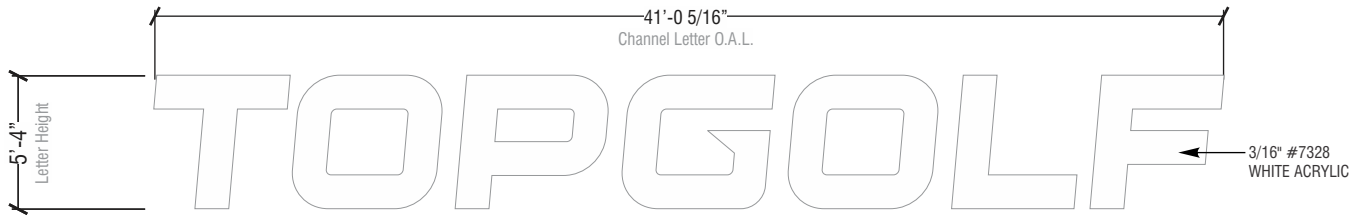

EZ



SELECT

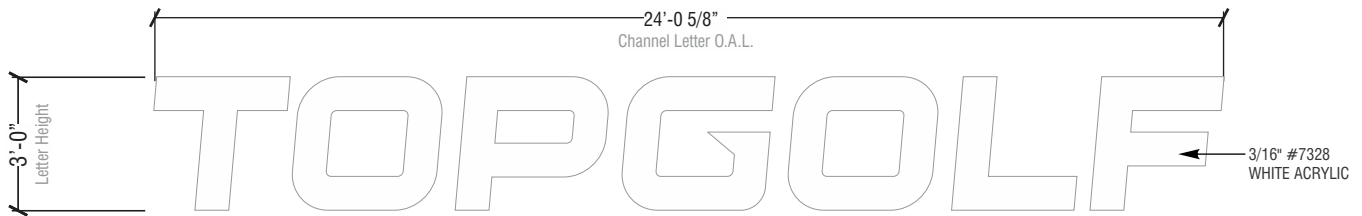

FLEX

* Size will vary with building location.

TOPGOLF WHITE CHANNEL LETTERS

COLORS & FINISHES

- P1. MP 46633 Brushed Alum. (Satin Finish) or 7686C Blue
 P2. PMS White (Satin Finish)
 P3. Match Canopy
 PF1. #7328 White
 PF2. Metallic Silver

SIGN CONSTRUCTION (Varies with Letter Size)

- FACE:** 3/16" Acrylic
- TRIM CAP:** 1" Wide Jewelite Chemically Bonded To Acrylic Face
- RETURNS:** .063" Aluminum Formed & Assembled W/ Welds & Silicone Based Adhesive Sealant
- BACKER:** 1/8" Thk. Aluminum Back w/ 1/4" Ø riv nuts @ gusset hardware only; electrical holes to accommodate listed liquid-tight flexible conduit connector.
- SCREWS:** #8 x 1/2" Truss head, Self Drilling, Self Tapping Screw
- DRAIN HOLES:** 1/4" Ø As Needed Per Letter W/ Light Baffle.
- ANGLE:** 3" x 2" x 3/16" thk. structural angle interior support welded to inside of backs @ thru bolt location.

ELECTRICAL (SIGN TO BE UL LISTED)

- LEDS:** 6500K White Principal Qwik Mod 3
- WIRE:** Secondary Low Voltage Led Wire
- FLEXIBLE CONDUIT:** Liquid Tight Flexible Conduit Or Approved Equal From Letter To Raceway.
- RACEWAY:** Fabricated aluminum raceway.
- CIRCUIT:** 120V/20 amp maximum supply circuit by others.

INSTALLATION HARDWARE (Varies with Letter Size)

- GUSSET:** 1/4" Thk. Aluminum Fabricated Gusset. See Appropriate Details Within This Drawing Package.
- HARDWARE:** 1/4" Ø Thru Bolt W/ 1/4" Washer. Min. 4 Per Letter. See appropriate details within this package.
- HARDWARE:** 3/8"-7 x 4 1/2", Grade A, zinc finished, hex head, lag bolt into blocking, Minimum (1) @ 18" O.C w/ 3/8" Ø galvanized bonded sealing washer. (1) per lag bolt. *Note: Installer to seal all penetrations w/ clear silicone sealant.*
- BLOCKING:** 2" x 6" Fire treated, exterior grade wood blocking between seams @ canopy system as req'd, mounted to face & top of canopy substrate by others.
- HARDWARE:** 1/4" Ø non-corrosive, grade 5, thru bolt behind letters only.

NOTE: Sign construction, electrical, and installation hardware varies with building style, letter size, and letter placement.





BUILDING SIGNS

CHANNEL LETTERS

WING WALL: SELECT



COLORS & FINISHES

- P1. MP 46633 Brushed Alum. (Satin Finish) or 7686C Blue
- P2. PMS White (Satin Finish)
- P3. Match Canopy
- PF1. #7328 White
- PF2. Metallic Silver

SIGN CONSTRUCTION (Varies with Letter Size)

1. **FACE:** 3/16" Acrylic
2. **TRIM CAP:** 1" Wide Jewelite Chemically Bonded To Acrylic Face
3. **RETURNS:** .063" Aluminum Formed & Assembled W/ Welds & Silicone Based Adhesive Sealant
4. **BACKER:** .080" thk. w/ P3 (interior) finish; electrical holes to accommodate listed liquid-tight flexible conduit connector.
5. **SCREWS:** #8 x 1/2" Truss head, Self Drilling, Self Tapping Screw
6. **DRAIN HOLES:** 1/4"Ø As Needed Per Letter W/ Light Baffle.

ELECTRICAL (SIGN TO BE UL LISTED)

7. **LEDS:** Listed Class 2, minimum Ip66, UV resistant, LED module.
8. **WIRE:** 12V secondary-circuit, listed class 2, 18/2 plenum rated wire
9. **FLEXIBLE CONDUIT:** Liquid Tight Flexible Conduit Or Approved Equal From Letter To Raceway.
10. **RACEWAY:** Fabricated aluminum raceway.
11. **CIRCUIT:** 120V/20 amp maximum supply circuit by others.

INSTALLATION HARDWARE (Varies with Letter Size)

12. **HARDWARE:** 1/4" Ø Thru Bolt W/ 1/4" Washer. Min. 4 Per Letter. See appropriate details within this package.
13. **HARDWARE:** 1/4"-10 x 8", Grade A, zinc finished, hex head, lag bolt into blocking. Minimum (4) per letter.
14. **HARDWARE:** 1" Ø non-corrosive anti-crush sleeve. EFS compatible sealant between sleeve & dryvit.

TOPGOLF WHITE CHANNEL LETTERS



WALL MOUNTING DETAIL

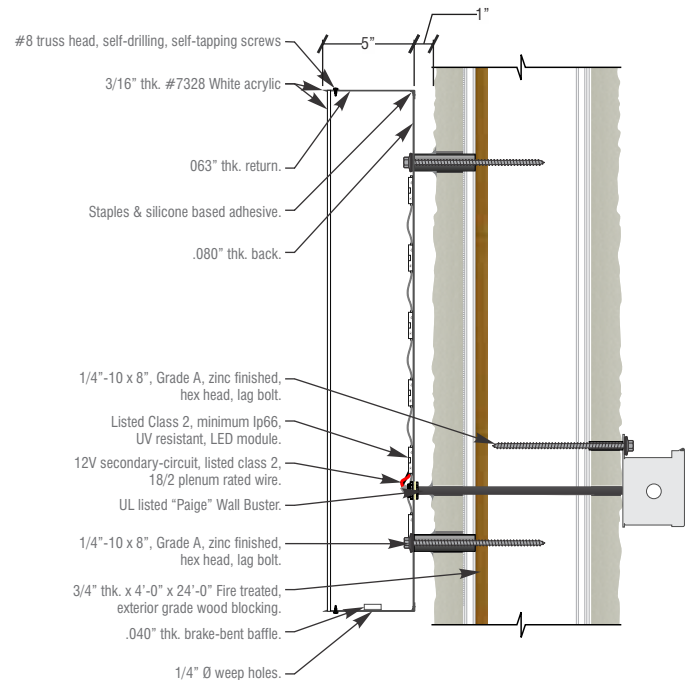

Example: Albuquerque, NM



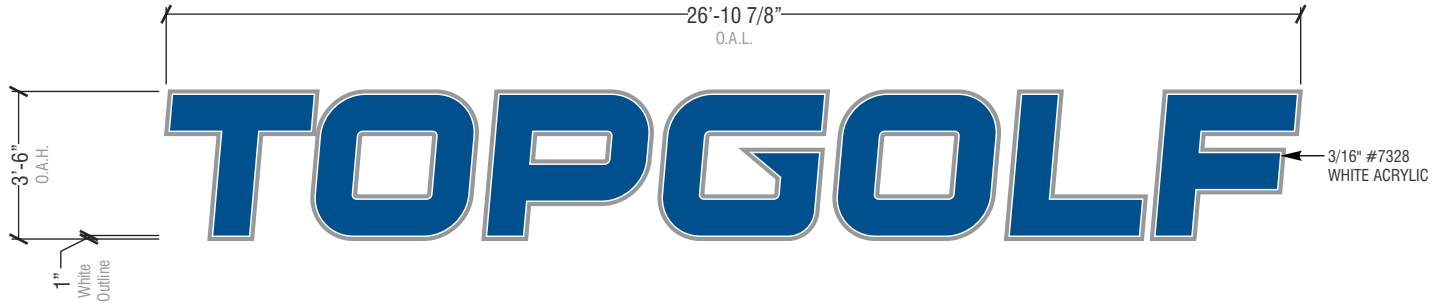

COLORS & FINISHES

- P1 MP 46633 Brushed Alum. (Satin Finish)
- P2 PMS White w/ satin finish
- P3 PMS Black C w/ satin finish
- V1 3M 3630-157 Sultan Blue Translucent Vinyl
- M1 3/16" thk. White Polycarbonate

SIGN CONSTRUCTION

Back:

1. 1/8" thk. aluminum interior back w/ P2 interior & P1 exterior.
2. 1/8" thk. x 6" x 6" plate welded to inside of letter to add support @ mounting locations.
3. 1/8" thk. seam plate to be welded in place w/ P2 finish.

Returns:

4. .063" thk. aluminum, formed & assembled w/ welds & silicone based adhesive sealant.
5. (1) - 1/4"Ø-1/2"Ø weep hole req'd @ every low point or isolated section of the sign.
6. .040" Thk. Break Bent Light Baffle, adhered to inside of return. Typical @ all Weep holes.
7. 1" x 1" x 1/8" thk. aluminum angle, notched & formed inside retainer.

Faces:

8. 3/16" White thk. poly-carbonate face. Typical @ all letters.
9. #10, truss head, self-drilling, self tapping screw to hold faces to inside retainer.

Retainer:

10. .090" thk. retainer, formed & welded w/ silicone based adhesive sealant to prevent water penetration & light leaks w/ P1 exterior
11. #8 truss head self-drilling, self-tapping screw w/ P1 finish.

ELECTRICAL (SIGN TO BE UL LISTED)

12. 6500K Listed Class 2, Minimum Ip66, UV Resistant, LED module.
13. 12V Secondary-circuit, listed Class 2, 12/2 plenum rated wire suitable for damp/wet locations in accordance w/ NEC 600.12, 725.3(L).
14. Listed liquid-tight flexible conduit connector & flexible conduit from letter.

INSTALLATION HARDWARE (Varies with Letter Size)

15. 3/16" thk. aluminum mounting plate w/ (4) 9/16"Ø holes for mounting
16. 4" x 4" x 3/16" thk. aluminum square tube finished P3.
17. 3/16" thk. aluminum mounting plate w/ (2) holes drilled & tapped to accommodate for a 1/4"-20 bolt & (1) 2 1/2"Ø electrical hole; finished P3.
18. 1/4"-20 x 1 1/2" long, non-corrosive hex head bolt. (2) per outrigger w/ No finish.
19. 1/4" Ø non-corrosive nut & washer. (1) per Outrigger Stud.
20. 3/8" Ø galvanized bonded sealing washer. (1) Per lag bolt req'd.
21. 3/8"-7 x 4 1/2" Grade A, zinc finished, hex head, lag bolt into blocking by others.

NOTE

Sign construction, electrical, and installation hardware varies with building style, letter size, and letter placement.

TOPGOLF BLUE CHANNEL LETTERS



DAY (Gen-2)



NIGHT (Gen-2)





BUILDING SIGNS CHANNEL LETTERS

WING WALL: GEN-2

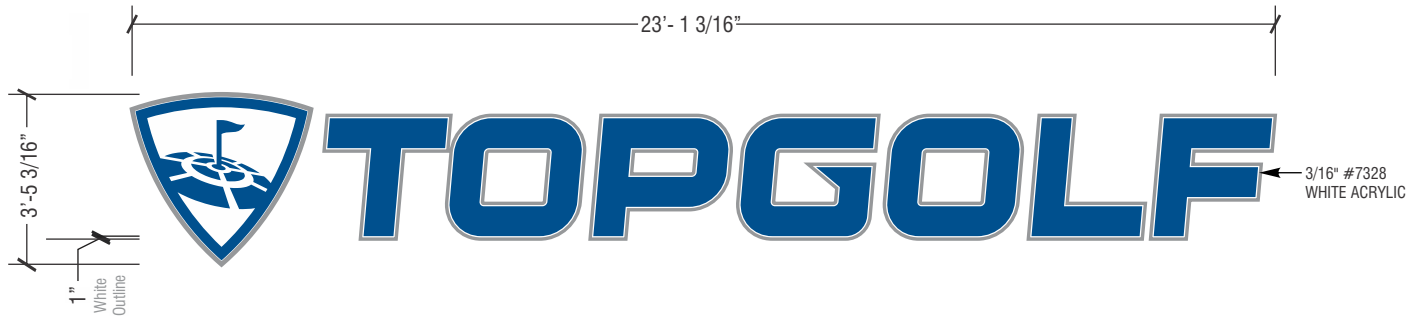

COLORS & FINISHES

- P1 Matthews Paint 41-342 Brushed Aluminum w/ Satin Finish
- P2 White w/ satin finish
- P3 Sherwin Williams 0023 Pewter Tankard w/ satin finish
- V1 Arlon 2500/2114 Blue
- M1 Metallic Silver trim cap
- M2 3/16" thk. #7328 White Acrylic

SIGN CONSTRUCTION

1. **Backs:** .080" thk. w/ P2 (interior) finish & 1/4" Ø riv nuts
2. **Returns:** .063" thk. notched & formed w/ P2 (interior) & P1 exterior finish.
3. Returns & backs assembled w/ staples & silicone based adhesive to prevent water penetration & light leaks.
4. **Faces:** M2 w/ first surface V1.
5. **Retainer:** 1" M1 jewelite aluminum reinforced trim cap retainer to be chemically bonded to acrylic face w/ Weld-on #4 & #16.
6. #8 truss head self-drilling, self-tapping, pan head screw finished to match retainer.
7. **Illumination:** Listed Class 2, minimum Ip66, UV resistant, LED module.
8. 12V secondary-circuit, listed class 2, 18/2 plenum rated wire suitable for damp/wet locations in accordance w/ NEC 600.12, 725.3(L).
9. 1/4" Ø weep holes req'd. @ all low points or isolated sections of the sign w/ no external obstructions in accordance w/ NEC 600.9(D).
10. .040" thk. brake-bent baffle assembled to inside of return @ drain holes & finished P2.
11. **Installation:** 1/4"-10 x 8", Grade A, zinc finished, hex head, lag bolt into blocking.
Minimum (4) per letter.
12. Neoprene Washer in accordance with Dryvit Outsulation system detail. (1) per lag bolt.
13. 1" Ø non-corrosive anti-crush sleeve. EIFS compatible sealant between sleeve & dryvit.
14. EIFS compatible sealant, *Dow Corning 790, 791, or 795*, around perimeter of sleeve @ face of EIFS.
15. UL listed "Paige" Wall Buster through 9/16" Ø hole drilled in EIFS facade.
16. Fabricated raceway finished to match P3.
17. 3/4" thk. x 4'-0" x 24'-0" Fire treated, exterior grade wood blocking behind EIFS.
18. 120V/20 amp maximum supply circuit by others.

TOPGOLF BLUE CHANNEL LETTERS WITH SHIELD



WALL MOUNTING DETAIL

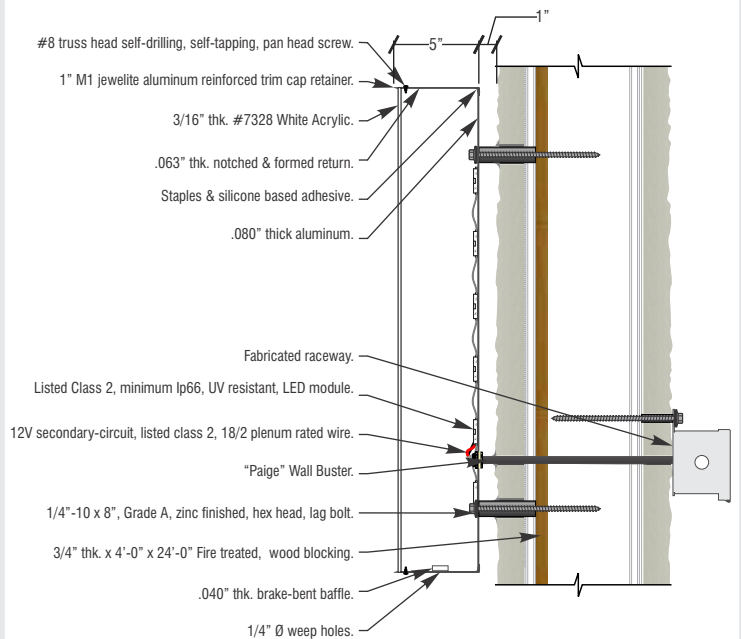



BUILDING SIGNS CHANNEL LETTERS

MAIN ENTRY: GEN-2 Alternate

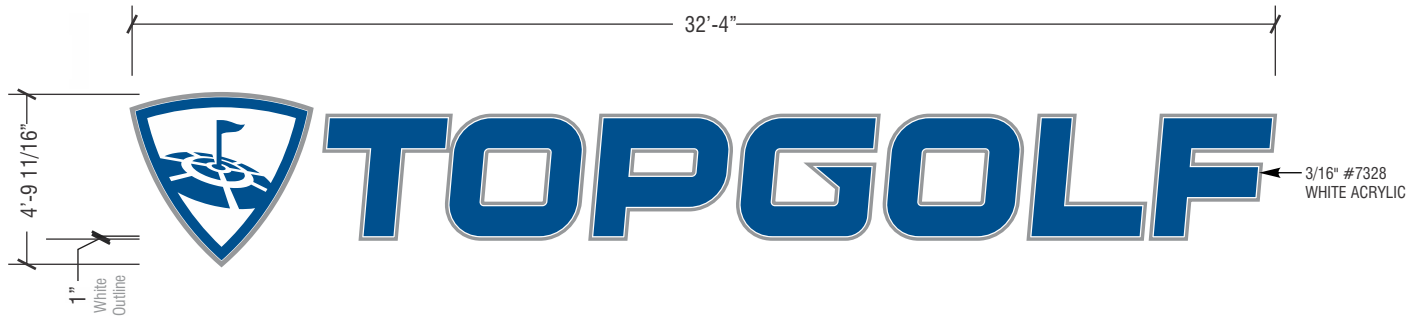

* Where LED EIFS not allowed.

COLORS & FINISHES

- P1 MP 46633 Brushed Alum. (Satin Finish)
- P2 PMS White w/ satin finish
- P3 PMS Black C w/ satin finish
- V1 3M 3630-157 Sultan Blue Translucent Vinyl
- M1 3/16" thk. White Polycarbonate

SIGN CONSTRUCTION

Back:

1. 1/8" thk. aluminum interior back w/ P2 interior & P1 exterior.
2. 1/8" thk. x 6" x 6" plate welded to inside of letter to add support @ mounting locations only & P2 Interior. (1) per Outrigger.
3. 1/8" thk. seam plate to be welded in place w/ P2 finish.

Returns:

4. .063" thk. aluminum, formed & assembled w/ welds & silicone based adhesive sealant to prevent water penetration & light leaks w/ P2 interior & P1 exterior.
5. (1) - 1/4"Ø-1/2"Ø weep hole req'd @ every low point or isolated section of the sign w/ no external obstructions in accordance w/ NEC 600.9(D).
6. .040" Thk. Break Bent Light Baffle, adhered to inside of return. Typical @ all Weep holes.
7. 1" x 1" x 1/8" thk. aluminum angle, notched & formed inside retainer.

Faces:

8. 3/16" White thk. poly-carbonate face. Typical @ all letters.
9. #8, truss head, self-drilling, self tapping screw to hold faces to inside retainer.

Retainer:

10. .090" thk. retainer, formed & welded w/ silicone based adhesive sealant to prevent water penetration & light leaks w/ P1 exterior
11. #8 truss head self-drilling, self-tapping screw w/ P1 finish.

ELECTRICAL (SIGN TO BE UL LISTED)

12. 6500K Listed Class 2, Minimum Ip66, UV Resistant, LED module.
13. 12V Secondary-circuit, listed Class 2, 12/2 plenum rated wire suitable for damp/wet locations in accordance w/ NEC 600.12, 725.3(L). All secondary wires are to be labeled @ terminal & junction locations for serviceability per NEC 725.30. Remote metal parts, such as LED Channel Letters, supplied by a remote class 2 power supply DO NOT need to be grounded per NEC 600.7(B)(1).
14. Listed liquid-tight flexible conduit connector & flexible conduit from letter for secondary low-voltage wiring.

TOPGOLF BLUE CHANNEL LETTERS WITH SHIELD



DAY (Orlando, Gen-2)



NIGHT (Auburn Hills, Gen-2)



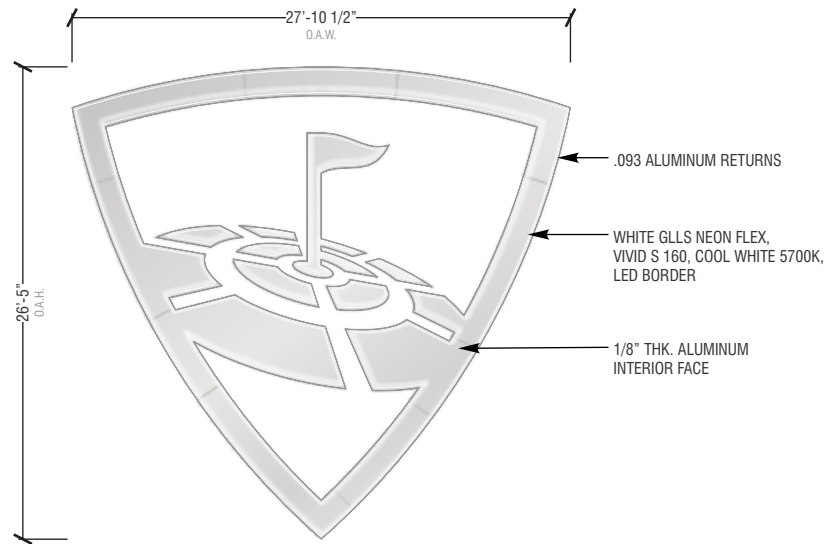

* Standard for Select Building Style

COLORS & FINISHES

- P1. **PAINT:** MP 46633 Brushed Alum. (Satin Finish)
 P2. **PAINT:** PMS Black C (Satin Finish)

SIGN CONSTRUCTION

- BACK:** 1/8" Aluminum Welded To Returns
- RETURNS:** .093 Aluminum Formed & Assembled W/ Welds & Silicone Based Adhesive Sealant
- SCREWS:** #8 x 1/2" Truss head, Self Drilling, Self Tapping Screw
- FACE:** 1/8" Thk. Aluminum Interior Face
- CHANNEL:** 2" X 4" Structural Channel Support Welded To Back.

ELECTRICAL (SIGN TO BE UL LISTED)

- LEDS:** White GLS Neon Flex, Vivid S 160, cool white 5700K, LED border w/ seamless back exit power.
- WIRE:** Secondary Low Voltage Led Wire
- PASS THRU:** Paige Wallbuster Or Approved Equal.

INSTALLATION HARDWARE

- OUTRIGGER:** Manufactured 3/16" Aluminum Outrigger (MFPT TG-OUTGR)
- HARDWARE:** 1/4"-20 X 1 1/2" Long, Non-corrosive Hex Head Bolt W/ 1/4" Washer. (2) Per Outrigger.
- HARDWARE:** 3/8"-7 x 2" Grade A, zinc finished, hex head, lag bolt W/ 3/8" Ø galvanized bonded sealing washer Screwed into blocking by others (4) Per Outrigger.
- EXTERIOR WALL:** Rainscreen System Over 3/4" Thk. Fire Rated & Pressure Treated Wood Blocking.

SPECIAL CONDITION

- CAP:** 1/8" Aluminum end cap/cover for each outrigger To prevent moisture/water to enter into building facade. Placed During Outrigger Installation But Prior To Letter Installation
- NUT:** 1/4" Nut.

PERIMETER LIT SHIELD LOGO



DAY (Omaha, NE)



NIGHT (Rogers, AZ)

LOW VOLT DETAILS

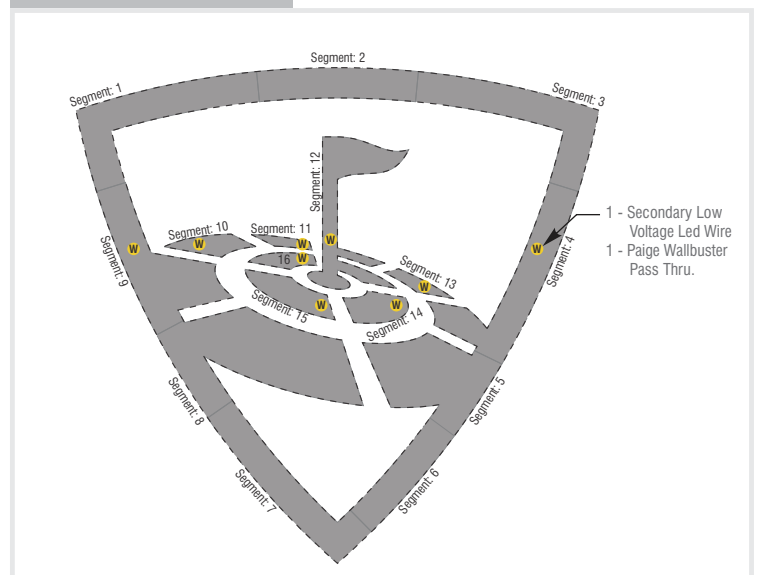



BUILDING SIGNS HALO LOGO

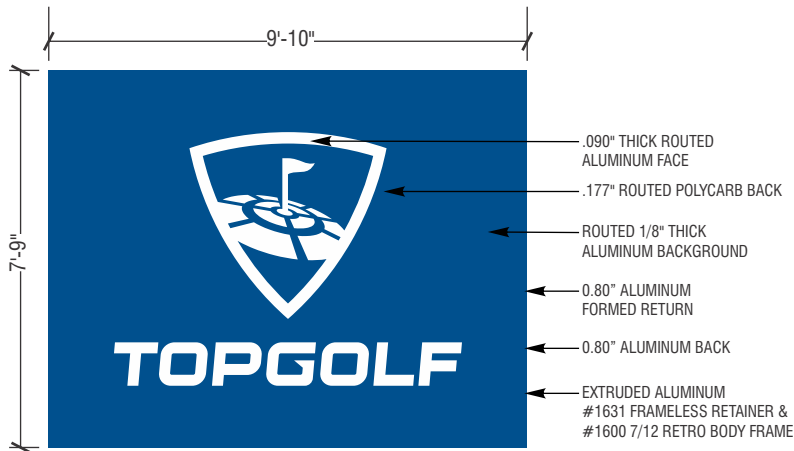

* Standard for Flex Building Style

COLORS & FINISHES

- P1. ☐ **LOGO, COPY & SPACERS:** Paint White (Satin Fin.)
 P2. ☒ **BACKGROUND:** Paint to Match PMS 7686C

- PF1. ☐ **BACK:** #2447 White

SIGN CONSTRUCTION

1. **FACES:** .090" Thick Routed Aluminum
2. **RETURNS:** .080" Formed Aluminum
3. **BACK:** .177" Routed Polycarb Pop-Riveted To Angle
4. **SPACERS:** 3/4"Ø X 1-1/2" Long
5. **BACKGROUND:** Routed 1/8" Thick Aluminum
6. **FRAME:** Extruded Aluminum #1631 Frameless Retainer & #1600 7/12 Retro Body
7. **BACK:** .080 Thick Aluminum
8. **HARDWARE:** #8 Flat Head Undercut Countersunk Screws Painted To Match Return
9. **HARDWARE:** 1/4"Ø Allthread w/Nuts & Washers
10. **HARDWARE:** 1/4"Ø Closure Screws On Sides & Bottom

ELECTRICAL (SIGN TO BE UL LISTED)

11. **LEDS:** 6300k White Class 2 Leds.
12. **WIRE:** Secondary Low Voltage Led Wire T
13. **PASS THRU:** Paige Wallbuster Or Approved Equal
14. **PASS THRU:** Liquid Tite or Approved Equal.
15. **POWER SUPPLY:** Class 2 Power Supply
16. **PRIMARY:** 1/2" Conduit To Disconnect Switch Secure To Wall w/Straps
17. **SERVICE SWITCH:** 20a Located On Side Of Background

INSTALLATION HARDWARE

18. **HARDWARE:** Min. 1/4"Ø Non-corrosive Hardware Into Wood Blocking. Anti-Crush Spacers At All Mounting Points. Min (10) Places.

BUILDING CONDITIONS

19. **WALL SURFACE:** Corrugated Metal Multi-Rib Panels Over Galvanized Steel Framing. Wood Blocking Behind Wall Surface. Corrugated Panel Details & Blocking Details TBD. To Be Coordinated Between Cima & Aria

HALO LOGO



DAY (Augusta, GA)



NIGHT (Augusta, GA)

WALL MOUNTING DETAIL

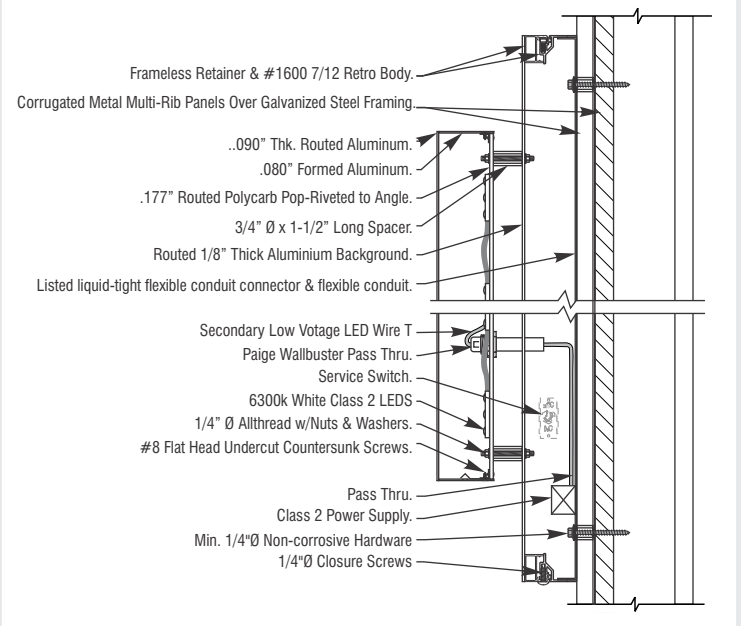



SHIELD CHANNEL LETTERS

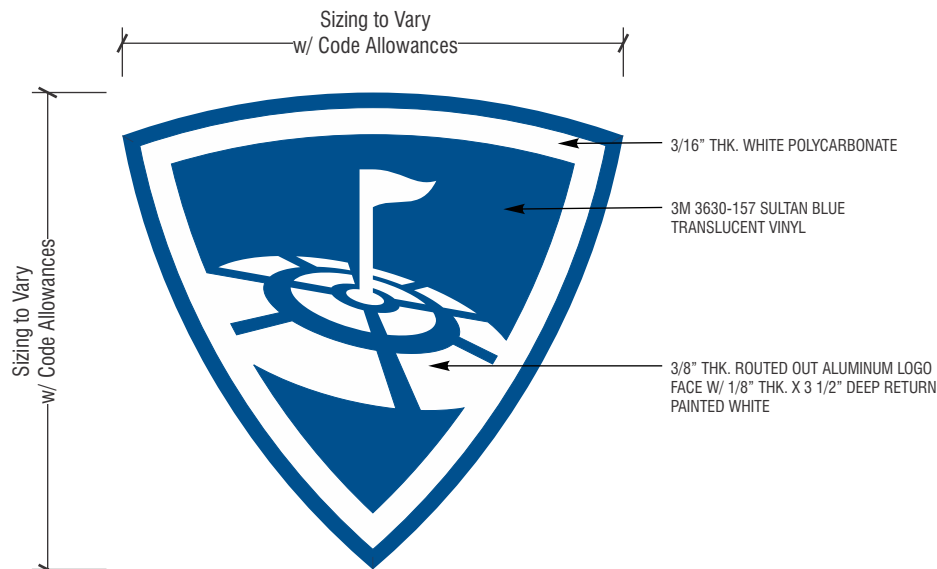

COLORS & FINISHES

- P1. ☐ **LOGO, COPY & SPACERS:** Paint White Satin Finish
 P2. ☒ **BACKGROUND:** Paint to Match PMS 7686C

- Pf1. ☐ **BACK:** #2447 White

SIGN CONSTRUCTION

- FACES:** .090" Thick Routed Aluminum
- RETURNS:** .080" Formed Aluminum
- BACK:** .177" Routed Polycarb Pop-Riveted To Angle
- SPACERS:** 3/4"Ø X 1-1/2" Long
- BACKGROUND:** Routed 1/8" Thick Aluminum
- FRAME:** Extruded Aluminum #1631 Frameless Retainer & #1600 7/12 Retro Body
- BACK:** .080 Thick Aluminum
- HARDWARE:** #8 Flat Head Undercut Countersunk Screws Painted To Match Return
- HARDWARE:** 1/4"Ø Allthread w/Nuts & Washers
- HARDWARE:** 1/4"Ø Closure Screws On Sides & Bottom

ELECTRICAL (SIGN TO BE UL LISTED)

- LEDS:** 6300k White Class 2 Leds.
- WIRE:** Secondary Low Voltage Led Wire T
- PASS THRU:** Paige Wallbuster Or Approved Equal
- PASS THRU:** Liquid Tite or Approved Equal.
- POWER SUPPLY:** Class 2 Power Supply Inside Spaced 1/2" Off Bottom Of Background
- PRIMARY:** 1/2" Conduit To Disconnect Switch Secure To Wall w/Straps (By Others)
- SERVICE SWITCH:** 20a Located On Side Of Background

INSTALLATION HARDWARE (Varies with Letter Size)

- HARDWARE:** Min. 1/4"Ø Non-corrosive Hardware Into Wood Blocking. Anti-Crush Spacers At All Mounting Points. Min (10) Places.

BUILDING CONDITIONS (Varies with Letter Size)

- WALL SURFACE:** Corrugated Metal Multi-Rib Panels Over Galvanized Steel Framing. Wood Blocking Behind Wall Surface.

TOPGOLF SHIELD CHANNEL LETTERS



DAY (Richmond, VA)



DAY (Cleveland, OH)

WALL MOUNTING DETAIL

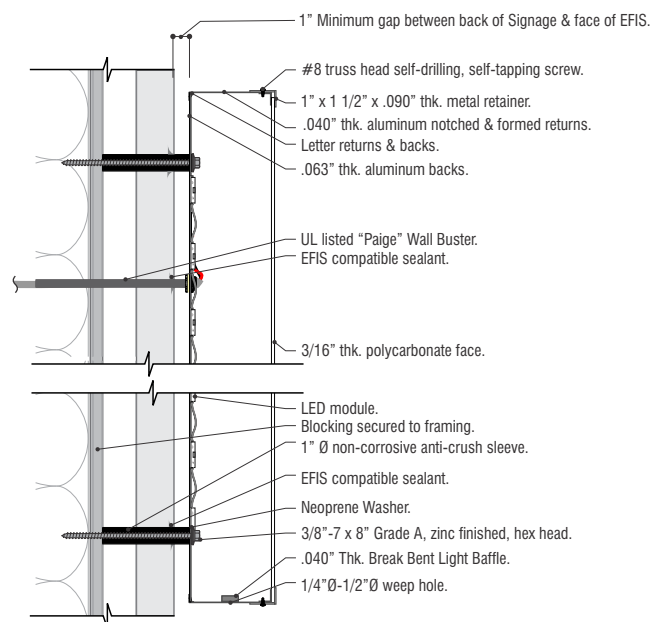

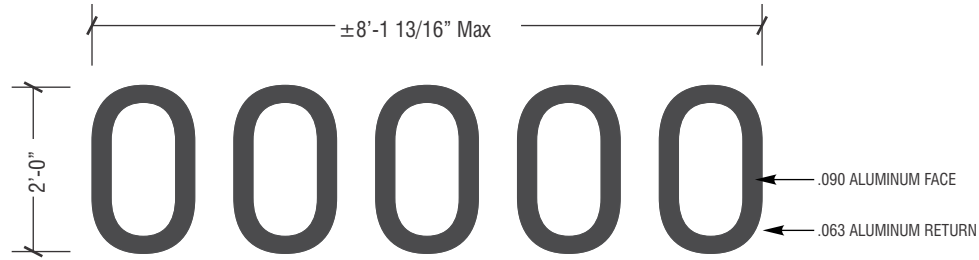

TOPGOLF ADDRESS DIMENSIONAL LETTERS - 14"

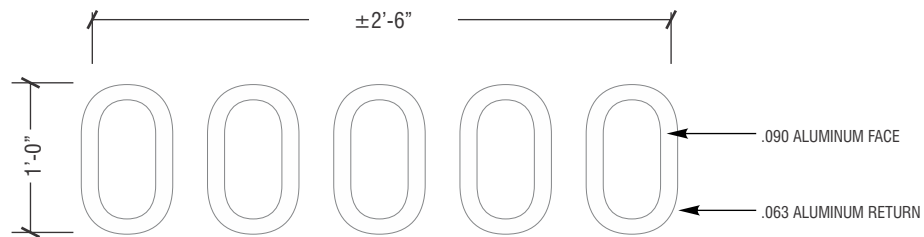

* Standard for Flex building.

COLORS & FINISHES

- P1. **PAINT:** SW 7069 Iron Ore (Satin Finish)
 P2. **PAINT:** PMS White C w/ satin finish.

SIGN CONSTRUCTION

- FACE:** .090 Aluminum
- RETURNS:** .063 Aluminum Formed & Assembled W/ Welds & Silicone Based Adhesive Sealant
- ANGLE:** 2" x 2" x 1/8" Aluminum Clips. (3) Per Digit
- HARDWARE:** #8 truss head, self-drilling, self-tapping screw finished to match

INSTALLATION HARDWARE

- HARDWARE:** 5/16"-9 x 3" Grade A, zinc finished, hex head, lag bolt into blocking. Minimum (3) per digit.
- HARDWARE:** 1" \varnothing non-corrosive anti-crush sleeve. EIFS compatible sealant between sleeve & dryvit. Typical @ All penetrations in accordance with Dryvit Outsulation system. (1) per mounting clip.
- BLOCKING:** 3/4" thk. x 4'-0" x 8'-0" Fire treated, exterior grade wood blocking behind EIFS.



SELECT (Rogers)

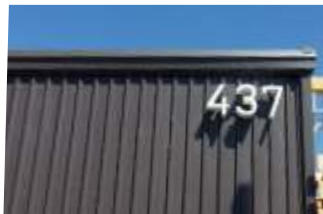

FLEX (Augusta)

TOPGOLF ADDRESS DIMENSIONAL LETTERS - 12"

ADDRESS MOUNTING DETAIL

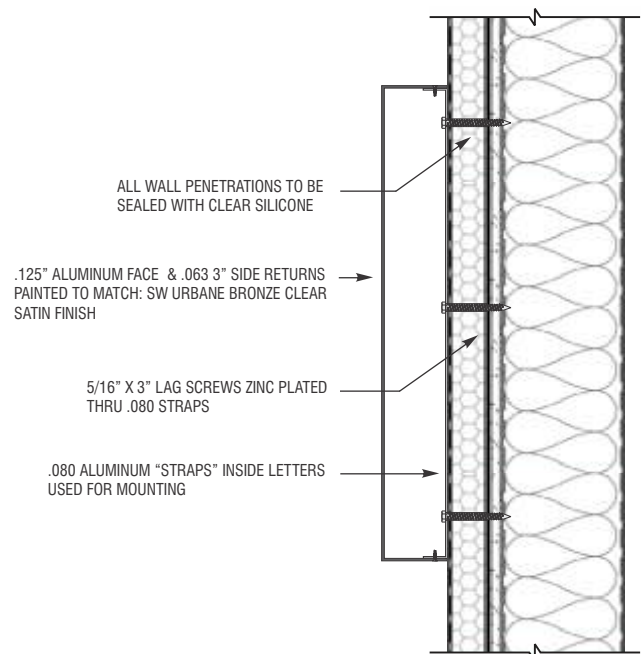



FREE STANDING SIGNS MONUMENT

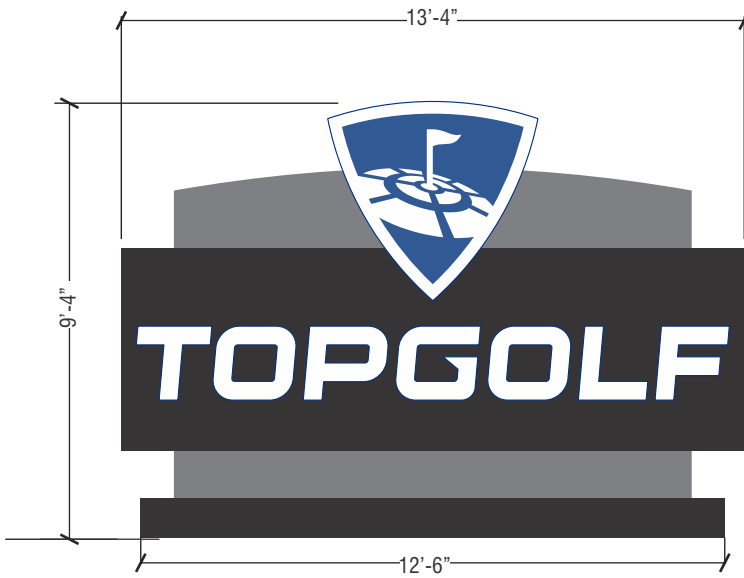

SIDE VIEW



TOP VIEW

* Sizing may vary based on code allowances.

COLORS & FINISHES

- P1. **PAINT:** PMS Black C (Satin Finish)
- P2. **PAINT:** PMS White (Satin Finish)
- P3. **PAINT:** Dark Grey (TBD)
- P4. **PAINT:** PMS 7686C w/ satin finish
- V1. **VINYL:** 3M 3630-157 Sultan Blue (Trans)
- PF1. **PRE-FINISHED:** #7328 White
- PF2. **PRE-FINISHED:** Blue

SIGN CONSTRUCTION

1. **FACE:** 3/16" Acrylic
2. **TRIM CAP:** 1" Wide Jewelite Chemically Bonded To Acrylic Face
3. **LOGO RETURNS:** .063" Aluminum Formed & Assembled W/ Welds & Silicone Based Adhesive Sealant
4. **COPY RETURNS:** .040" Aluminum Formed & Assembled W/ Staples & Silicone Based Adhesive Sealant
5. **LOGO BACKER:** .090" Thk. Aluminum Back/baffle
6. **COPY/HOUSING BACKER:** .063" Thk. Aluminum Back
7. **SCREWS:** #8 x 1/2" Truss head, Self Drilling, Self Tapping Screw
8. **DRAIN HOLES:** 1/4" Ø As Needed Per Letter W/ Light Baffle.

ELECTRICAL (SIGN TO BE UL LISTED)

9. **LEDS:** 6500K White Principal Qwik Mod 3
10. **WIRE:** Secondary Low Voltage Led Wire
11. **PASS THRU:** Paige Wallbuster Or Approved Equal.
12. **POWER SUPPLY:** Principal 12V DC Class 2 Power Supply Inside Enclosure.
13. **ENCLOSURE:** Paige Box Or Approved Equal
14. **PRIMARY:** 1/2" Conduit To Disconnect Switch Secure To Wall w/Straps
15. **SERVICE SWITCH:** Toggle Switch & Guard W/ Lock-out Capability Located On End Of Enclosure

INSTALLATION HARDWARE

16. **HARDWARE:** 1/4" Ø Thru Bolt W/ 1/4" Washer. Min. 3 Per Letter

TOPGOLF MONUMENT SIGN

FOOTING NOTES

1. Minimum concrete strength shall be 3,000 PSI
2. Concrete design and construction to be in accordance with ACI 318-08 per / FBC 2010
3. Concrete poured into constrained earth excavations must cure under proper conditions for 4 days prior to sign box installation.
4. For pier and caisson footings, concrete must be poured against undisturbed earth.
5. Maintain a minimum of 4" cover between bottom of support pole and bottom of concrete footing on all direct burial footings.

TYPICAL FOUNDATION DESIGN

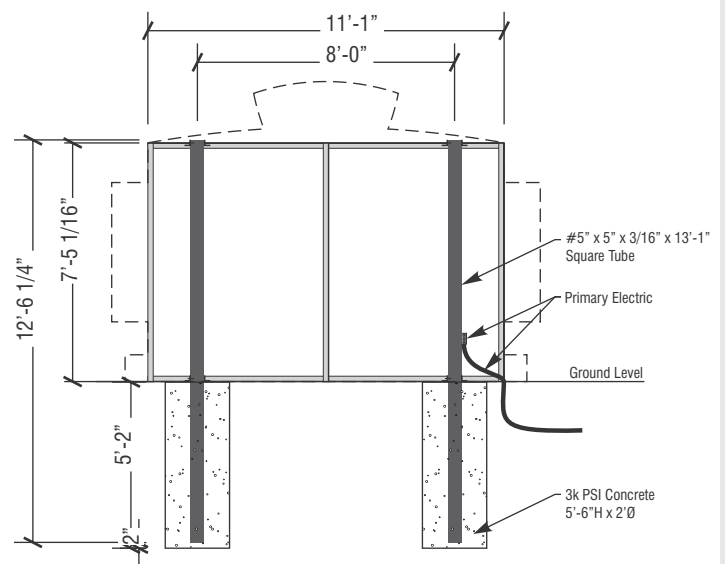



FREE STANDING SIGNS MONUMENT

VALUE ENGINEERED ALTERNATE DESIGN

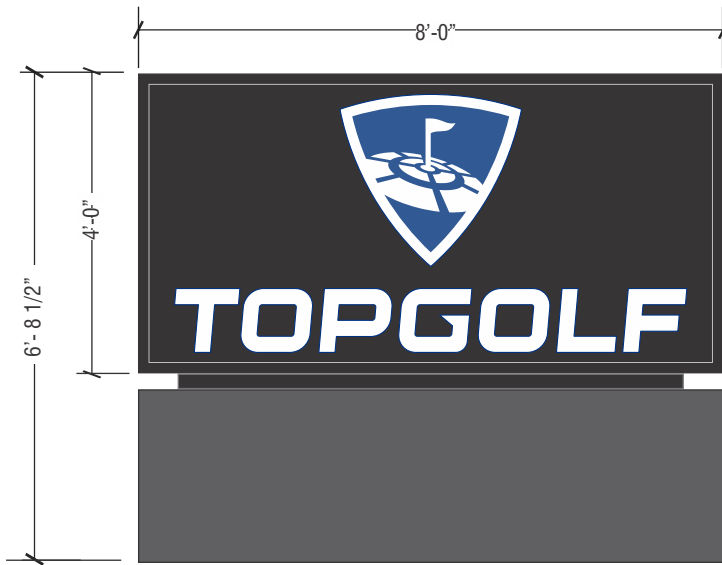

SIDE VIEW

* Sizing may vary based on code allowances.

COLORS & FINISHES

- PF1. **FACE:** White Acrylic
P1. **CABINET & RETAINER:** Brushed Aluminum (Satin Finish)
P2. **STUB & PLATE:** Paint Dark Gray
V1. **VINYL:** 3M 3630-157 Sultan Blue (Trans)
V2. **VINYL:** 1st Surface 3M 7725-22 Opaque Matte Blk

FACE CONSTRUCTION

1. **FACE:** 3M P3 Flex Face w/ 1st Surface Vinyl

CABINET CONSTRUCTION

2. **CABINET:** Extruded Aluminum Painted P1
3. **RETAINER:** Sign Comp #2065 Extruded Aluminum Dual Frame Retainer
4. **FRAME BRACE:** Sign Comp Aluminum
5. **FRAME BRACE SUPPORT TUBE:** Sign Comp Aluminum

STRUCTURAL STEEL

6. **SUPPORT POLES:** (2) 5" x 5" x 1/4" Square Steel Tubes. Pass Thru Plates & Weld Joints On Both Sides
7. **STOP PLATE:** 3/4" Thick 13" x 13" Steel
8. **RINGS:** 3/8" Thick 11" x 11" Steel
9. **EXISTING STEEL:** Varies

ELECTRICAL (SIGN TO BE UL LISTED)

15. **LED:** (17) Hanley HPEB-2S96 DF Sticks.
16. **POWER SUPPLY:** (1) 100w & (2) 240w Hanley 24v Power Supplies Spaced 1/2" Off Bottom Of Case.
17. **SWITCH:** 20 Amp Service Switch With Rubber Boot In Junction Box

TOPGOLF MONUMENT SIGN

FOOTING NOTES

1. Minimum concrete strength shall be 3,000 PSI
2. Concrete design and construction to be in accordance with ACI 318-08 per / FBC 2010
3. Concrete poured into constrained earth excavations must cure under proper conditions for 4 days prior to sign box installation.
4. For pier and caisson footings, concrete must be poured against undisturbed earth.
5. Maintain a minimum of 4" cover between bottom of support pole and bottom of concrete footing on all direct burial footings.

TYPICAL FOUNDATION DESIGN

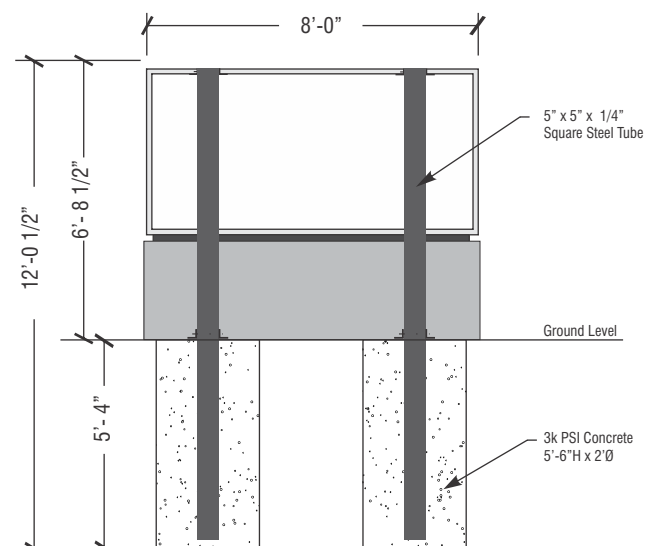



FREE STANDING SIGNS PYLON

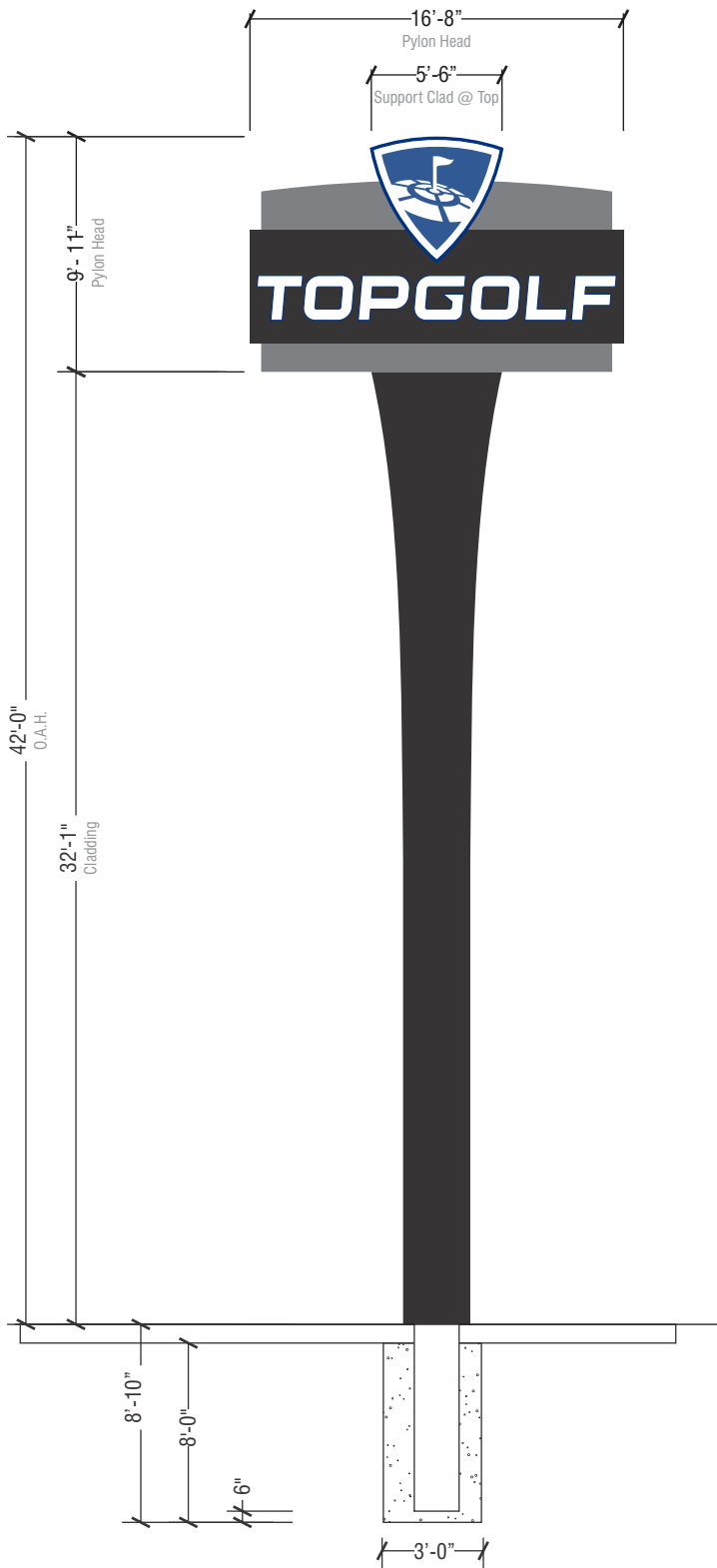

*Pylon height and header sizing may vary based on code allowances.

TOPGOLF PYLON SIGN



NIGHT (Chattanooga, TN)



NIGHT (National Harbor, MD)

COLORS & FINISHES

- P1 Dark Grey (TBD)
- P2 PMS White C w/ satin finish
- P3 PMS Black C w/ satin finish
- P4 PMS 288C w/ satin finish
- V1 Arlon 2500/2114 Blue
- M1 1" "Jewelrite" aluminum reinforced Blue trimcap retainer
- M2 3/16" thk. #7328 White Acrylic

SIGN DESCRIPTION

1. P3 Fabricated Main Support Cabinet.
2. P1 Fabricated Letter Carrier.
3. P3 Fabricated Support Clad.
4. P4 "TOPGOLF" Channel Letters.
5. M2 "TOPGOLF" Channel Letter Faces w/ M1 retainers & internally illuminated w/ 6500K white LED modules.
6. P4 Shield Logo Cabinet w/ first surface V1 & M1 retainer; internally illuminated w/ 6500K white LED modules.

TYPICAL FOUNDATION DESIGN

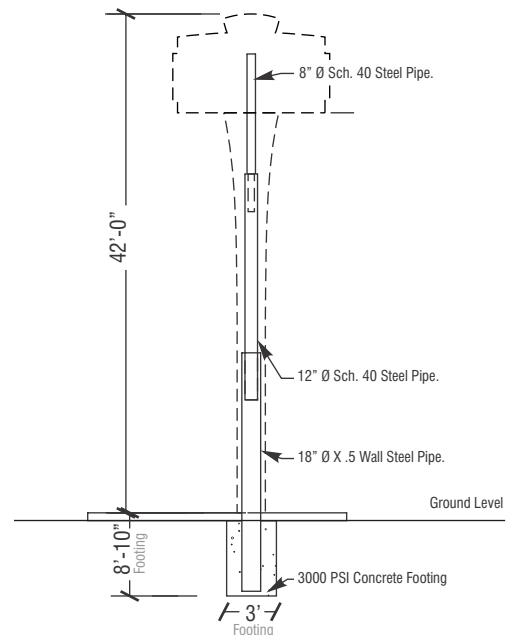

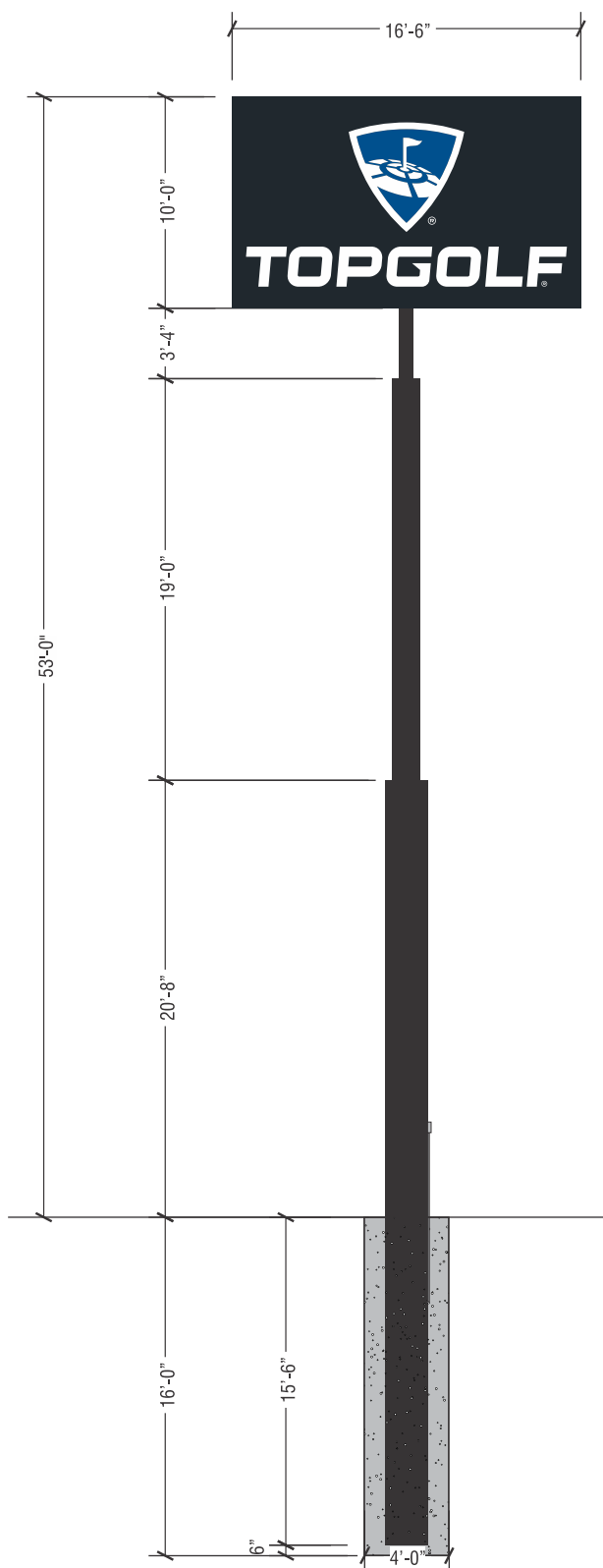



*Pylon height and header sizing may vary based on code allowances.

TOPGOLF PYLON SIGN

COLORS & FINISHES

- P1 **PRE-FINISHED:** White
P2  **PRE-FINISHED:** Black
P3  **SHIELD:** 3M 3630-157 Sultan Blue

FACE CONSTRUCTION

1. **MATERIAL:** 3M P3 Flex Face
2. **BACKGROUND:** Black Blockout

SIGN DESCRIPTION

1. *P3* Fabricated Main Support Cabinet.
2. *P1* Fabricated Letter Carrier.
3. *P3* Fabricated Support Clad.
4. *P4* "TOPGOLF" Channel Letters.
5. *M2* "TOPGOLF" Channel Letter Faces w/ *M1* retainers & internally illuminated w/ 6500K white LED modules.
6. *P4* Shield Logo Cabinet w/ first surface *V1* & *M1* retainer; internally illuminated w/ 6500K white LED modules.

TYPICAL FOUNDATION DESIGN

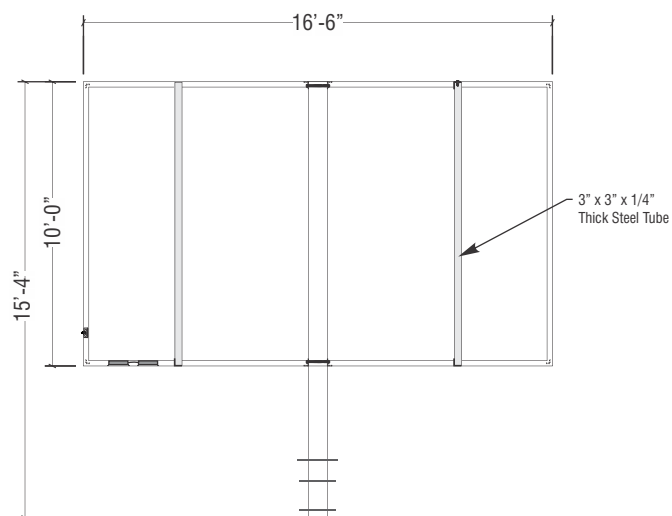



FREE STANDING SIGNS

MULTI-TENANT PANELS

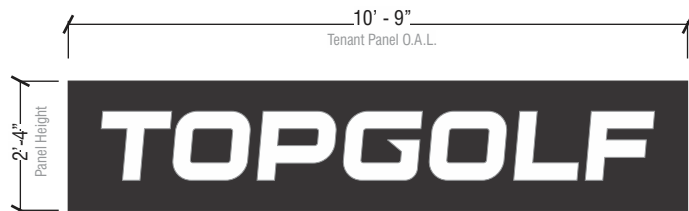
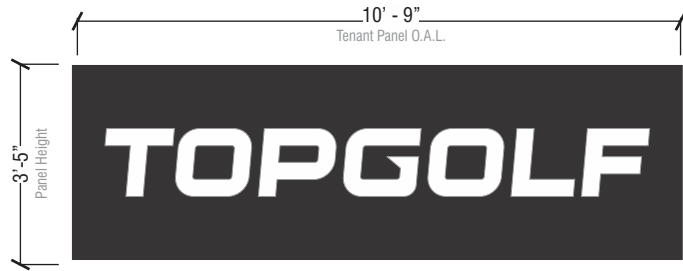

TOPGOLF MULTI-TENANT PANELS

Colors & Finishes

PF1 **FACE:** Black .177" Thick Acrylic

D1 **VINYL:** Digital Print

Sign Construction

Panel:

1. PF1 acrylic panel, w/ first surface direct digital print D1

Installation:

2. Clean surface thoroughly prior to install.

Note: Layout to be determined by actual space available.

MULTI-TENANT EXAMPLES

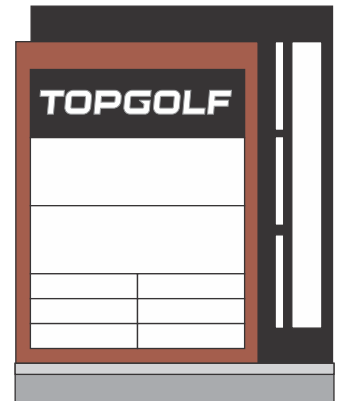
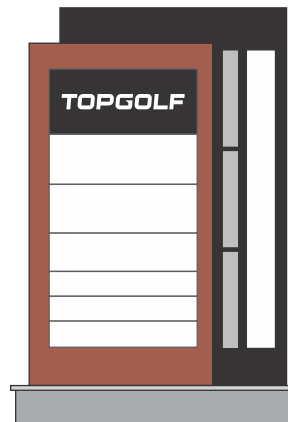



MISCELLANEOUS SIGNS WAYFINDING

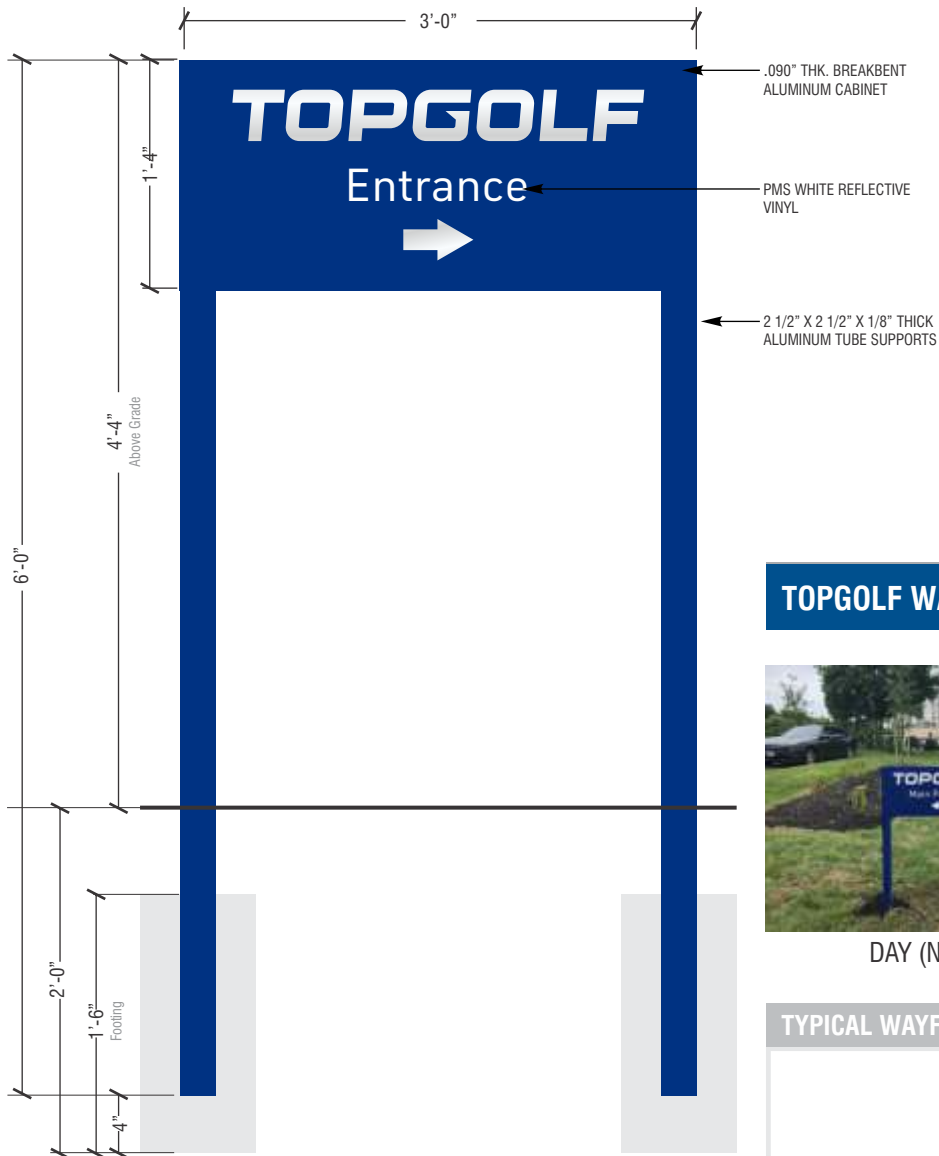

COLORS & FINISHES

- P1.  **LOGO, COPY & SPACERS:** Paint White (Satin Fin.)
P2.  **BACKGROUND:** Paint to Match PMS 7686C

SIGN CONSTRUCTION

- FACE:** .090" thk. brake bent aluminum cabinet finished to match PMS 288C w/ satin finish & first surface White reflective vinyl copy.
- SUPPORT:** 1/2" x 2 1/2" x 1/8" thk. aluminum tube supports finished to match PMS 288C w/ satin finish & directly embedded into concrete footing.

TOPGOLF WAYFINDING SIGN



DAY (National Harbor, MD)



DAY (National Harbor, MD)

TYPICAL WAYFINDING DIRECTIONALS





MISCELLANEOUS SIGNS ASPHALT STENCIL

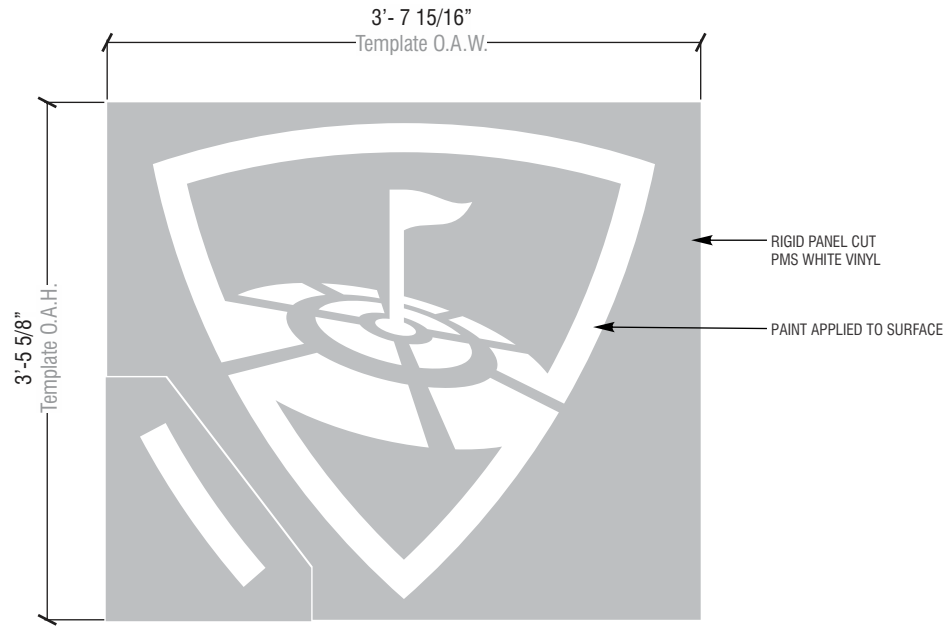

COLORS & FINISHES

P1 ☐ PMS White
P2 ☒ PMS 7686C

SIGN CONSTRUCTION

1. **STANDARD:** Surface applied paint
ALTERNATE: Rigid Panel Cut Sintra As Shown.

TOPGOLF ASPHALT STENCIL



DAY (National Harbor, MD)





MISCELLANEOUS SIGNS HIGHWAY PANELS

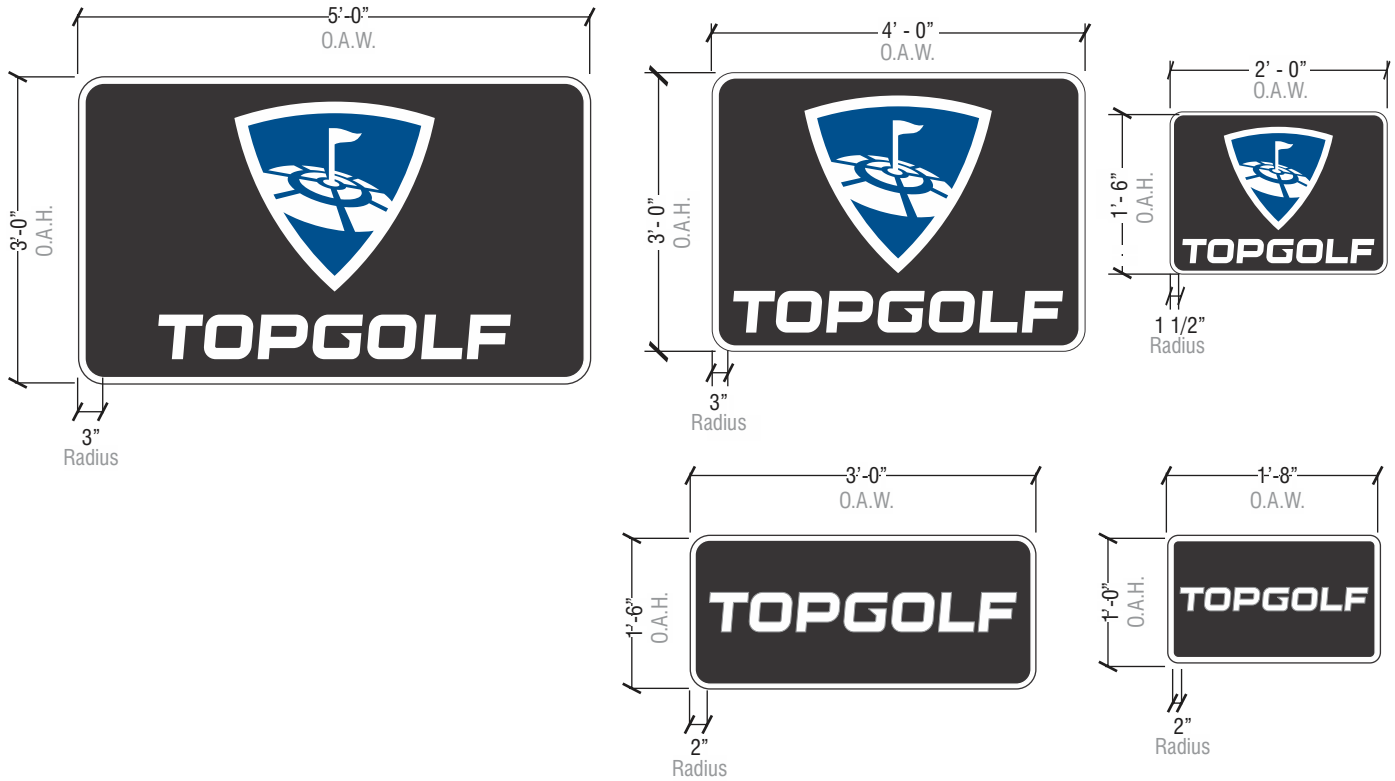

ATTRACTION PANEL OPTIONS

COLORS & FINISHES

- P1. **LOGO, COPY & SPACERS:** Paint White (Satin Fin.) or white vinyl
P2. **BACKGROUND:** Paint Black

SIGN CONSTRUCTION REQUIREMENTS

1. All signs must be retroreflective. The sign blank shall be fabricated from flat sheet aluminum of between .074 inch minimum and .125 inch maximum thickness.
2. The mounting holes are to be drilled with a No. 30 drill (.128 inch diameter) at the locations shown for individual signs.

SIGN CONSTRUCTION

1. **FACE:** .080 Aluminum
2. **DIGITAL PRINT:** Laminated and applied directly to face.

TOPGOLF HIGHWAY PANELS





GALLERY CUSTOM SIGNS





Germantown, MD



Augusta, GA



Hillsboro, OR



Tampa Bay, FL



Las Vegas, NV



Richmond, VA

